

1st Draft of Planting Plan for PPG Butterfly Habitat Area:
 A Joint Project of PPG Team Monarch, Wildlife Habitat
 Council, Carnegie Science Center & ASSET Inc.

Total area 100 x 100 ft.

Plant list for PPG Butterfly Habitat Area

Butterfly Garden

- Butterfly Bush (*Buddleia*) [n]
- Wild False Indigo (*Baptisia australis*) [l, n]
- Cosmos (annual) [n]
- Zinnias (annual) [n]
- Lupine (*Lupinus perennis*) [l, Karner's Blue, n]
- Hardy Ageratum (*Eupatorium coelestinum*) [n]
- Cup Plant (*Sylphium perfoliatum*)
- Golden Alexander (*Ziza aurea*) [l, Black swallowtail]
- Black-Eyed Susan (*Rudbeckia fulgida 'Goldsturm'*) [n]
- Aster 'Purple Dome' (*Aster novae-anglie*) [n]
- Switchgrass 'Heavy Metal' [l]
- Solidago 'Fireworks' [n]
- Blue Mist Shrub (*Caryopteris*) [N]
- Purple Coneflower (*Echinacea purpurea*) [n]

Short Grass Prairie

- Swamp Milkweed (*Asclepias incarnata*) [l, n]
- Butterfly Weed (*Asclepias tuberosa*) [l, n]
- Smooth Aster (*Aster laevis*) [l, n]
- New England Aster (*Aster nova-anglie*) [n]
- Arrow-Leaved Aster (*Astersagittifolius*) [n]
- Turtlehead (*Chelone glabra*) [l, Baltimore Checkerspot, n]
- Coreopsis (*tripteris? lanceolata?*) [n]
- Joe Pye Weed (*Eupatorium perfoliatum*) [n]
- Blazing Star (*Liatris spicata*) [n]
- Bee Balm (*Monarda didyma*) [n]
- Bergamont (*Monarda fistulosa*) [n]
- Wild Quinine (*Parthenium integrifolium*) [n]
- Goldenrod (*Solidago*) [n]
- Blue Vervain (*Verbena hastata*) [n]
- Little Bluestem (*Schizachyrium scoparium*) [n]

Tall Grass Prairie

- Same showy plans as in Short Grass Prairie plus:
- Indiangrass (*Sorghastrum nutans*) [l]
- Switchgrass (*Panicum virgatum*) [l]
- Ox Eye Sunflower (*Helianthus helianthoides*) [n]
- Ironweed (*Vernonia novebor*) [n]

Milkweed Patch

- Common Milkweed (*Asclepias syrica*) [l, n]
- Volunteer wildflowers

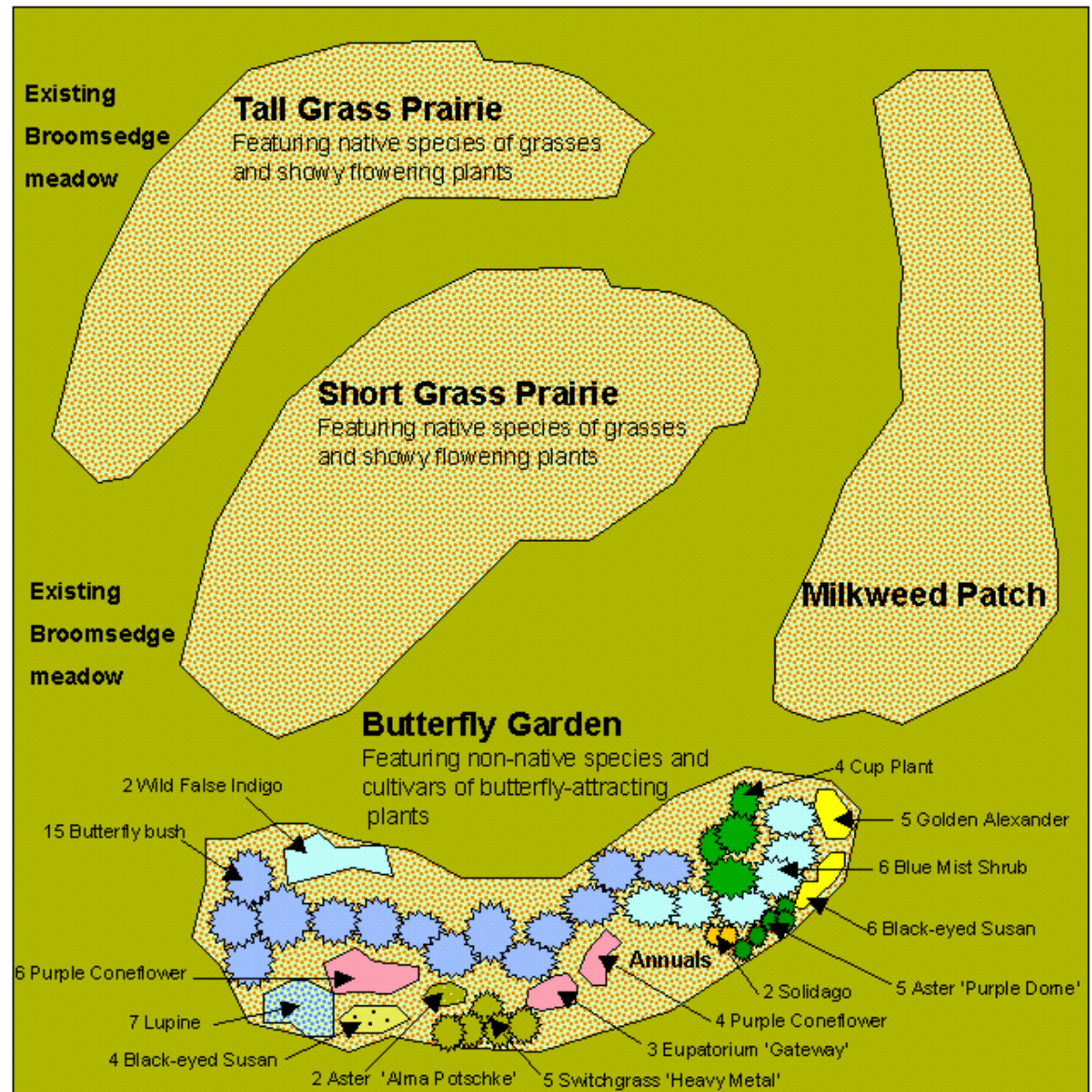

(Planting plan by T. Redick/ASSET Inc./2000)